



1. Installation and commissioning may only be carried out by authorised specialists and wired in cordance with the latest IEE electrical regulations or the national standards.
2. Mains power must be switched off before carrying out installation.
3. The manufacturer, shall not be liable for any damage resulting from inappropriate modifications to the luminaire or faulty installation.



4. Caution, risk of electric shock.
- The control gear provides basic insulation between the LV supply and the control circuit.



You can help protect the environment!
Please remember to respect the local regulations: hand in non-working electrical equipment to an appropriate waste disposal centre. The packaging material is recyclable. Dispose of the packaging in an environmentally friendly manner and make it available for the recyclable material collection service.

Product Description	SAP Code	Wattage	Current	Voltage	PF	CRI	Ta	CCT
CIRCLINE 450 3800-940	96295124	32W	0.15A	220-240V	>0.95	>90	-15~+40°C	4000K

Surface mount

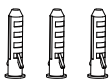
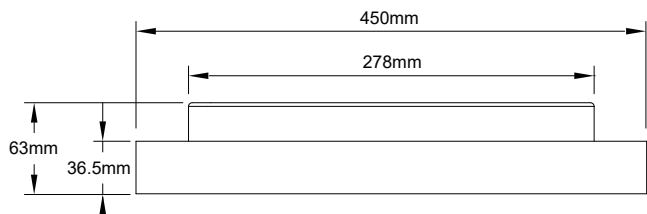

3PCS



3PCS

Dimension(mm)			
D1	D2	H1	H2
450	278	63	36.5

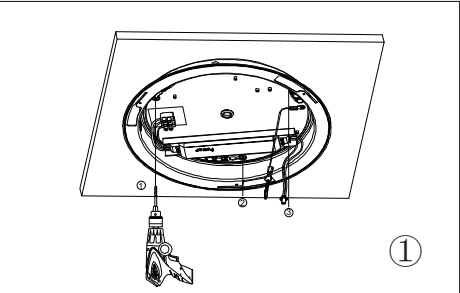

①

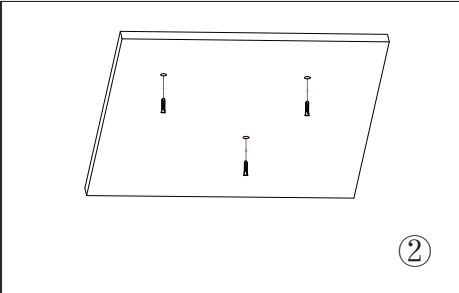

②

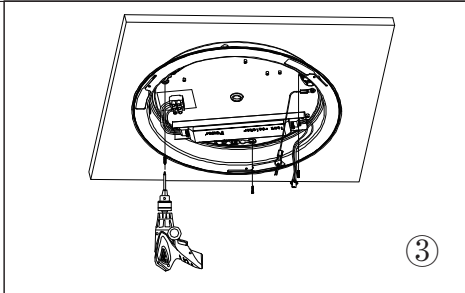

③

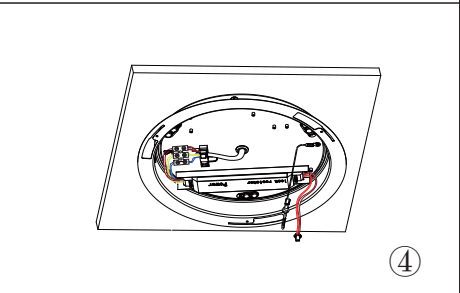

④

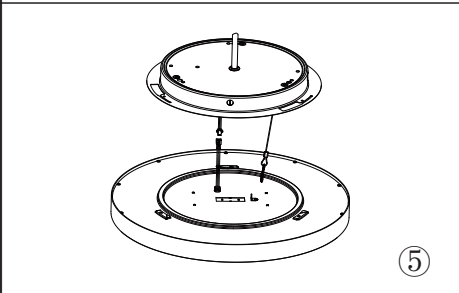

⑤

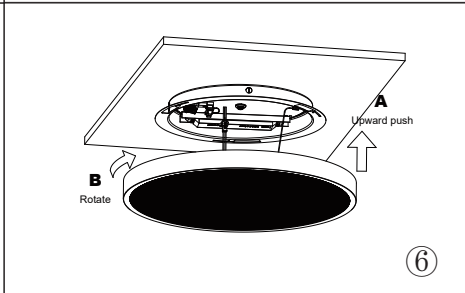

⑥

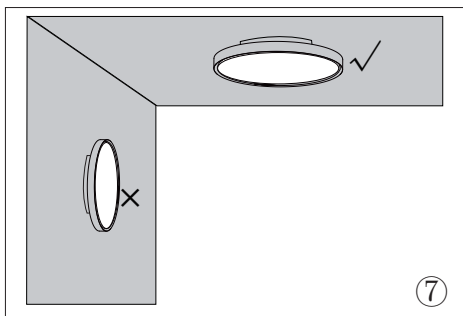

Suspension installation

Accessory pack (ordered separately)

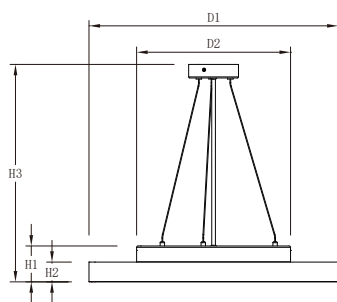

Dimension(mm)				
D1	D2	H1	H2	H3
450	278	63	36.5	1265

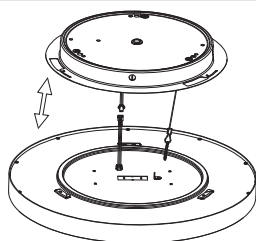
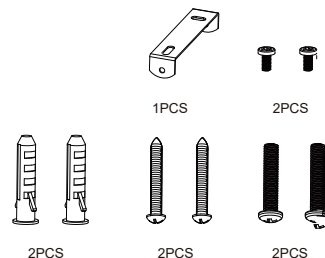

①

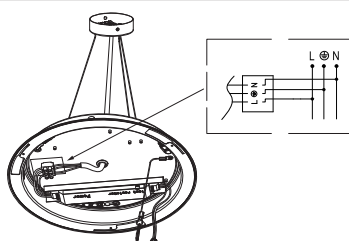

②

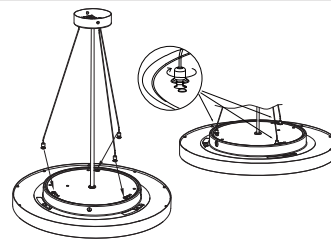

③

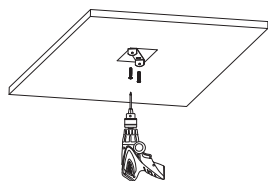

④

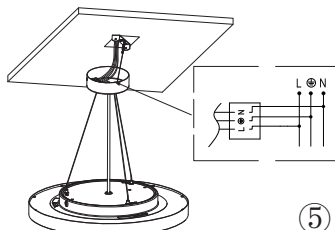

⑤

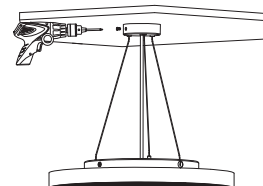

⑥

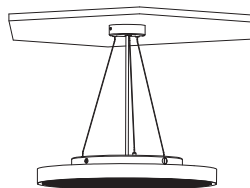

⑦

Wiring

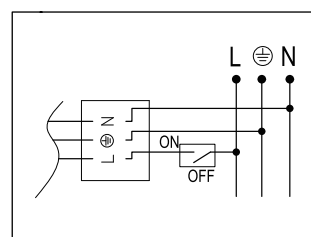
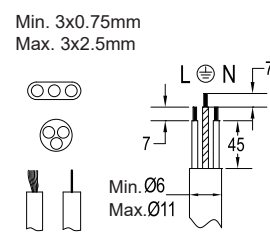
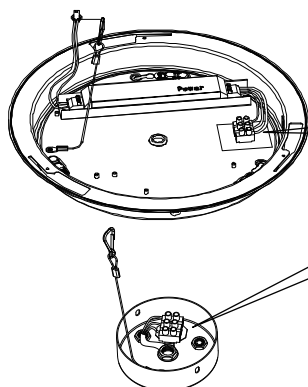

Wattage range(W)	Output current	Driver switch setting	
96295124		1	2
21W	200mA	-	-
26W	250mA	ON	-
32W	300mA	-	ON

