

EN Installation Instructions



1. Installation to be carried out by a qualified electrician in accordance with local wiring regulations. Ensure that the rated voltage and frequency of the luminaire are compatible with the electrical supply.
2. Disconnect mains supply before installing, servicing or maintaining the luminaire.
3. The manufacturer, shall not be liable for any damage resulting from inappropriate modifications to the luminaire or faulty installation.



4. The light source contained in this luminaire shall only be replaced by the manufacturer or their service agent or a similar qualified person.
5. The light source can't be replaced. The control gear provides basic insulation between the LV supply and the control circuit.
6. Specification: These luminaires are designed to comply with the requirements of AS/NZS 60598 and AS/NZS 2293.

SAP code	Product Description	EAN
96294584	VOYAGER IP65 EXIT 24M E2M	9415167080283

Length*Width*Height	381*98*190
Power consumption	3W
Input Voltage	220-240V AC, 50/60Hz
Battery	Lithium-iron phosphate (LiFePO4)
Charging time	16 hours
Autonomy	3 hours
Temperature	0°C to 40°C
Operating mode	Maintained with manual test switch (inside luminaire)
Viewing distance	24m
Spacing classification	C0=E2.5, C90=D2.0
Ingress protection	IP65
Material/finish	Polycarbonate
Mounting	Ceiling, Wall
Warranty	5 years luminaire, 3 years battery

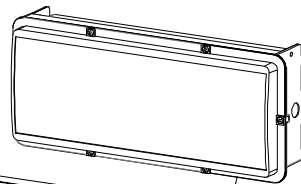
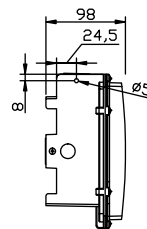
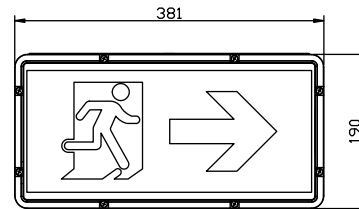

1	x1
2	x1
3	x1
4	x1
5	x1
6	x1

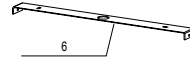
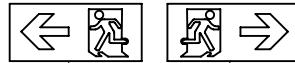

Ceiling Installation

1

In accordance with the relevant parts of AS/NZS 2293 determine a suitable location for installation.

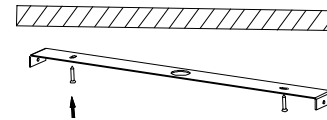

Install the bracket to the ceiling.

2

Remove the screws from the frame to open the fitting.

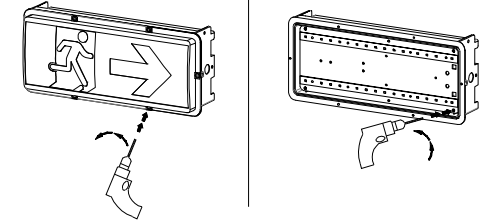

This allows the diffuser and frame to be removed. Carefully remove the screws from the corners of the LED housing.

3

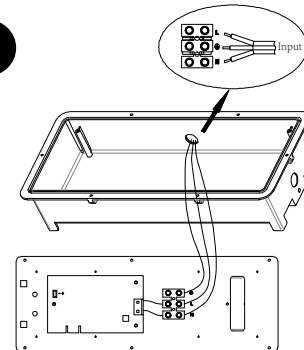

Connect the wiring to the terminal block.

4

Re-assemble the LED housing.

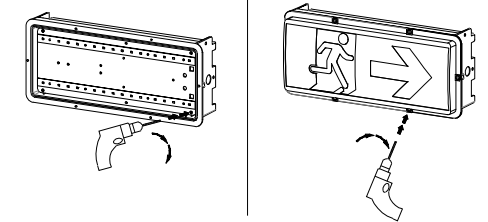

When the internal batteries have had a period of time to charge, the test switch inside the luminaire will allow you to spot check correct functionality.

5

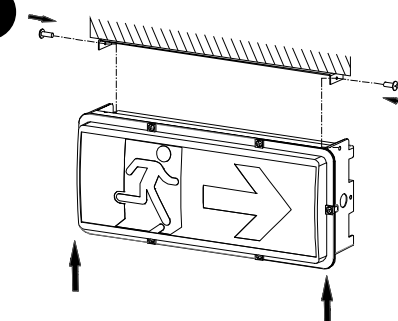

Align the fitting with the ceiling bracket and secure it with the screws provided.

Determine the appropriate signage screens to use based on the installation location. Ensure that hands are clean and no dirt or dust can be trapped beneath the screens.

Place the signage screens onto the diffuser and hold them into place by fitting the frame over the diffuser.

NB- Take care not to crease the sign media or damage the edges.

Re-attach the diffuser and frame and fix with screws.



Wall Mount Installation

THORN

Ceiling and Wall Mount Installation

- 1** In accordance with the relevant parts of AS/NZS 2293 determine a suitable location for installation.

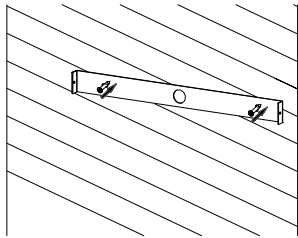

Install the bracket to the wall.

- 2** Remove the screws from the frame to open the fitting.

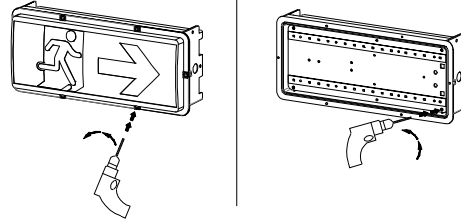

This allows the diffuser and frame to be removed. Carefully remove the screws from the corners of the LED housing.

- 3**

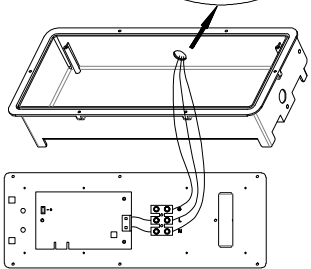

Connect the wiring to the terminal block.

- 4** Re-assemble the LED housing.

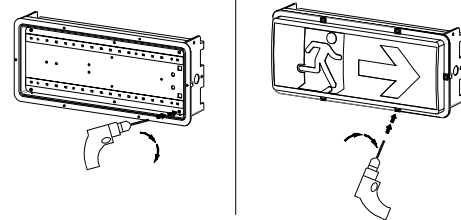

When the internal batteries have had a period of time to charge, the test switch inside the luminaire will allow you to spot check correct functionality.

Determine the appropriate signage screens to use based on the installation location. Ensure that hands are clean and no dirt or dust can be trapped beneath the screens.

Place the signage screens onto the diffuser and hold them into place by fitting the frame over the diffuser.

NB- Take care not to crease the sign media or damage the edges.

Re-attach the diffuser and frame and fix with screws.

- 5**

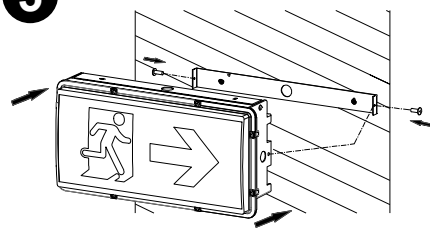

Align the fitting with the wall bracket and secure it with the screws provided.

- 6** Test The Luminaire

When the internal batteries have a period of time to charge, the test switch on the side of the luminaire will allow you to spot check correct functionality. The charge indicator illuminates when in operation.

In accordance with the requirements of AS/NZS 2293, once the luminaire is installed and fully charged, you will need to conduct a commissioning discharge test.

The Australian, New Zealand standards require newly installed emergency luminaires to operate in emergency mode for 2 hours.

Subsequent maintenance testing is required every 6 months and testing is required to be recorded in a suitable service logbook.

